

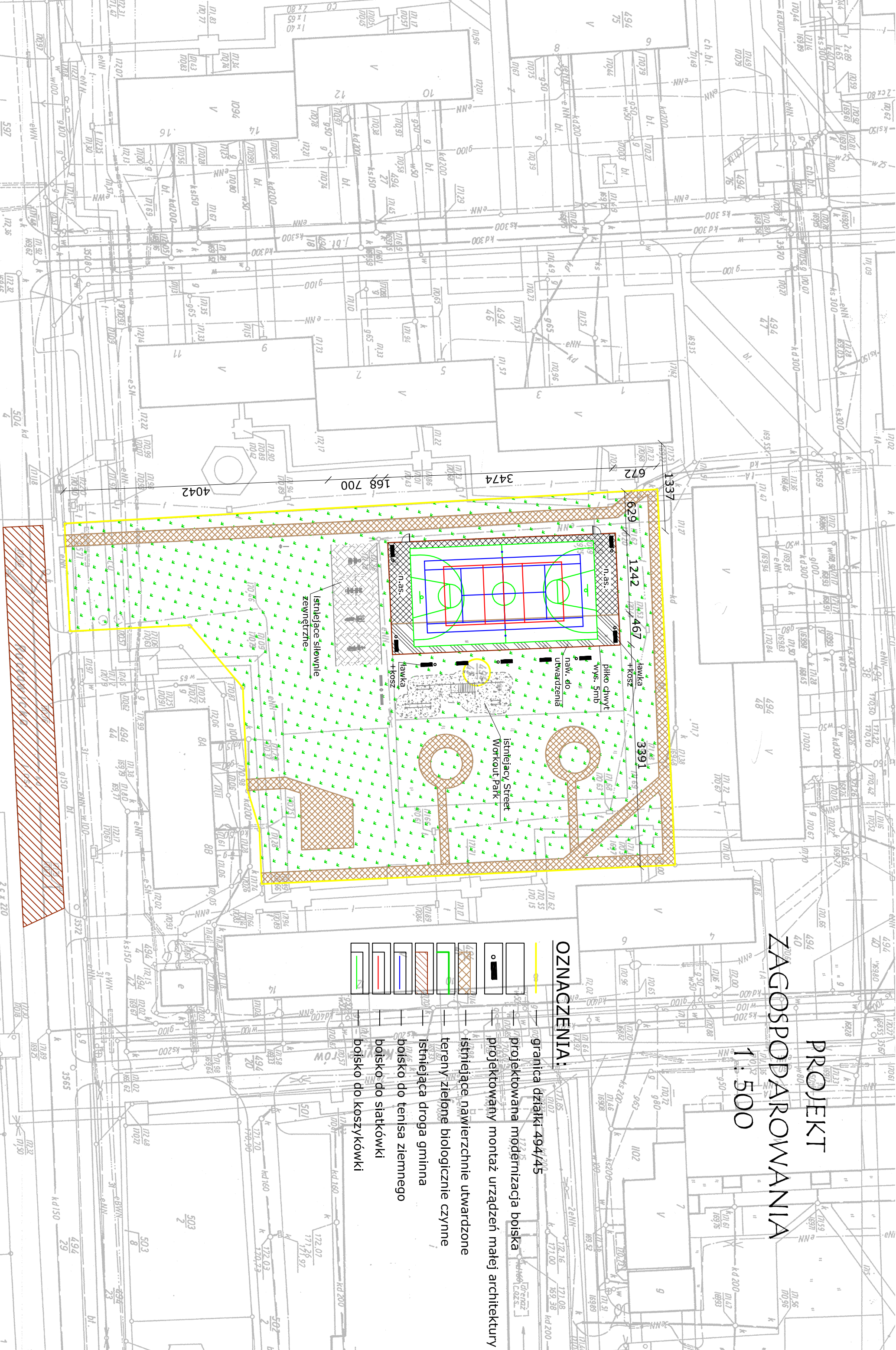





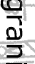
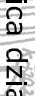

# PROJEKT ZAGOSPODAROWANIA

1:500



## ZNACZENIA:

-  granica działki 494/45
-  projektowana modernizacja boiska
-  projektowany montaż urządzeń małej architektury
-  istniejące nawierzchnie utwardzone
-  tereny zielone biologicznie czynne
-  istniejąca droga gminna
-  boisko do tenisa ziemnego
-  boisko do siatkówki
-  boisko do koszykówki